

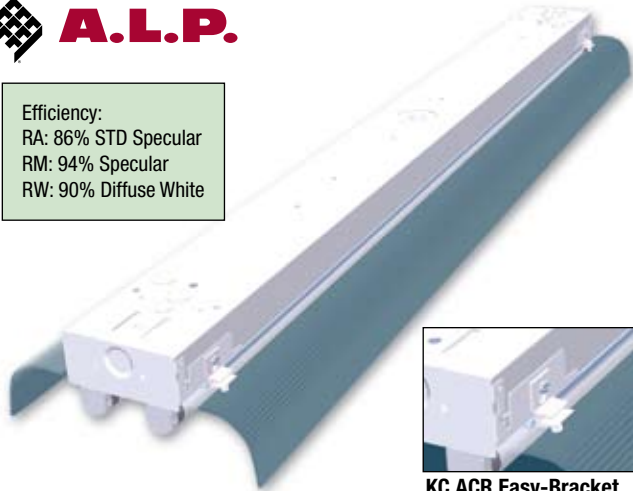

Efficiency:
 RA: 86% STD Specular
 RM: 94% Specular
 RW: 90% Diffuse White



KC ACR Easy-Bracket
 Easy-to-Install Clip

The compound acrylic and high reflectance metal reflector system of the A.L.P. KC ACR Retrofit Kit delivers a new level of performance and control for open lamp luminaires.

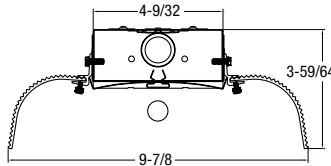

Flexible: Engineered to upgrade most strip and industrial luminaires with either T5 or T8 lamps.

Dramatically reduced contrast ratios and source brightness control improves visual performance.

Effective: Linear Acrylic Reflector combines precise reflection and refraction to manage brightness while delivering evenly distributed indirect illumination.

Efficient: Total luminaire efficiency exceeds 90%.

Attractive: Virgin acrylic prism geometry adds sparkle to any application.

4-ft and Tandem 8-ft Kits

KCACR RMT8 1	1 Lamp T8 Acrylic / Specular Reflector Kit	Incl (1) Reflector, (2) RW 501, (4) Clips, (2) Acrylic Reflectors
KCACR RMT8 2	2 Lamp T8 Acrylic / Specular Reflector Kit	Incl (1) Reflector, (2) RW 501, (4) Clips, (2) Acrylic Reflectors
KCACR RMT5 1	1 Lamp T5 Acrylic / Specular Reflector Kit	Incl (1) Reflector, (2) RWT5 501T5, (4) Clips, (2) Acrylic Reflectors
KCACR RMT5 2	2 Lamp T5 Acrylic / Specular Reflector Kit	Incl (1) Reflector, (2) RWT5 501T5, (4) Clips, (2) Acrylic Reflectors
KCACR RMT8 1TAN	2 Lamp Tandem T8 Acrylic / Specular Reflector Kit	Incl (2) Reflector, (2) RW 501, (1) RW 511, (4) Clips, (2) Joiner Clips (4) Acrylic Reflectors
KCACR RMT8 2TAN	4 Lamp Tandem T8 Acrylic / Specular Reflector Kit	Incl (2) Reflector, (2) RW 501, (1) RW 522, (4) Clips, (2) Joiner Clips (4) Acrylic Reflectors
KCACR RMT5 1TAN	2 Lamp Tandem T5 Acrylic / Specular Reflector Kit	Incl (2) Reflector, (2) RW 501, (1) RW 522, (4) Clips, (2) Joiner Clips (4) Acrylic Reflectors
KCACR RMT5 2TAN	4 Lamp Tandem T5 Acrylic / Specular Reflector Kit	Incl (2) Reflector, (2) RW 501T5, (1) RW 522T5, (4) Clips, (2) Joiner Clips (4) Acrylic Reflectors

Note: Reflector also available in white finish. Replace "RM" with "RW"

Acrylic Reflector Kit Only

KCACR4	4-ft Acrylic Reflector with Clips	(2) Acrylic side Panels, (4) Clips
KCACR8	8-ft Acrylic Reflector with Clips	(4) Acrylic side panels, (4) Clips, (2) Joiner Clips

KC ACR™ Compound Acrylic Retrofit Solutions
 for T5 and T8 Strip / Industrial Retrofit Kit

KC ACR™ Compound Acrylic Retrofit Solutions

for T5 and T8 Strip / Industrial Retrofit Kit

KCACR RWT8 2

Lamps: (2) F32T8 / SP35 Linear Fluorescent
Ballast: Sylvania QT2X32 T8/120 ISN-SC

ZONAL LUMEN SUMMARY

ZONE	LUMENS	%BARELAMP	%LUMINAIRE
0-30	990	17.4	19.5
0-40	1672	29.3	32.8
0-60	3255	57.1	63.9
0-90	4675	82.0	91.8
90-120	252	4.4	4.9
90-130	335	5.9	6.6
90-150	401	7.0	7.9
90-180	415	7.3	8.2
0-180	5091	89.3	100.0

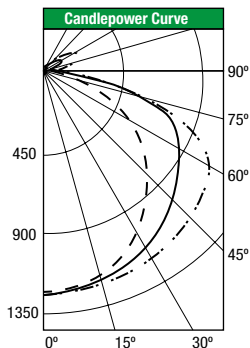

COEFFICIENTS OF UTILIZATION

Room Cavity Ratio	CEILING CAVITY REFLECTANCE											
	80				70				50			
	70	50	30	10	70	50	30	10	50	30	10	
0	105	105	105	105	101	101	101	101	95	95	95	
1	94	89	85	81	86	83	79	81	78	75		
2	84	77	70	64	81	74	68	62	70	64	60	
3	76	66	58	52	73	64	57	51	60	54	49	
4	69	58	49	43	67	56	48	42	53	46	41	
5	63	51	43	36	61	50	42	36	47	40	35	
6	58	46	37	31	56	44	36	31	42	35	30	
7	54	41	33	27	52	40	32	27	38	31	26	
8	50	37	29	24	48	36	29	24	35	28	23	
9	46	34	26	21	45	33	26	21	32	25	21	
10	43	31	24	19	42	31	24	19	29	23	18	

ITL Report Number:
ITL54967

KCACR RMT8 2

Lamps: (2) F32T8 / SP35 Linear Fluorescent
Ballast: Sylvania QT2X32 T8/120 ISN-SC

ZONAL LUMEN SUMMARY

ZONE	LUMENS	%BARELAMP	%LUMINAIRE
0-30	1249	21.9	23.3
0-40	2047	35.9	38.3
0-60	3661	64.2	68.4
0-90	4922	86.4	92.0
90-120	240	4.2	4.5
90-130	328	5.8	6.1
90-150	412	7.2	7.7
90-180	428	7.5	8.0
0-180	5351	93.9	100.0

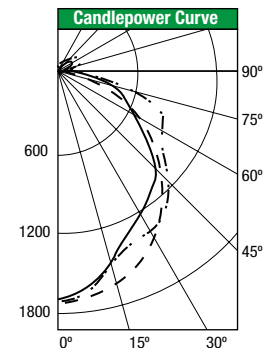

COEFFICIENTS OF UTILIZATION

Room Cavity Ratio	CEILING CAVITY REFLECTANCE											
	80				70				50			
	70	50	30	10	70	50	30	10	50	30	10	
0	110	110	110	110	107	107	107	107	100	100	100	
1	100	95	91	87	96	92	88	85	87	83	81	
2	90	82	75	70	87	80	73	68	75	70	66	
3	82	72	64	57	79	70	62	56	66	59	54	
4	75	63	55	48	72	61	54	47	58	51	46	
5	69	56	48	41	66	55	47	41	52	45	40	
6	63	51	42	36	61	49	41	35	47	40	35	
7	59	46	37	32	56	45	37	31	42	36	30	
8	55	42	34	28	53	41	33	28	39	32	27	
9	51	38	30	25	49	37	30	25	36	29	24	
10	48	35	28	23	46	34	27	23	33	27	22	

ITL Report Number:
ITL54966